

New Age Profile Routing Tools with Replaceable Tips

Multi Profile System Type A

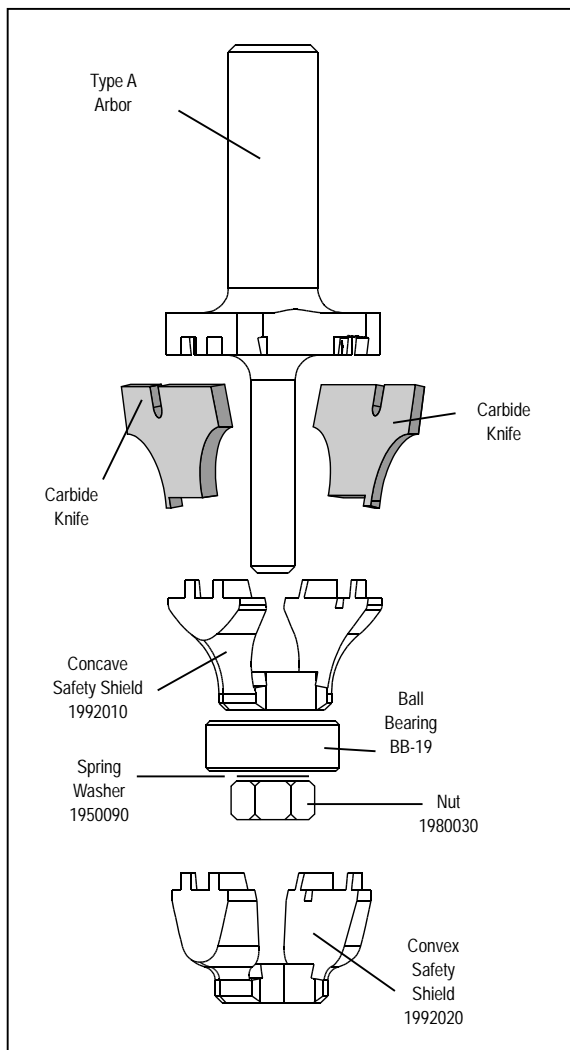

It's a whole workshop of options in a single Router Bit

The new Multi Profile System gives you a wide range of profiling options in a single Router bit with Replaceable Carbide Tips.

This New Age Router bit System, developed by DIMAR, puts the power of greater precision, better performance and higher versatility into your hands.



Why Choose The Multi Profile System?

Durability

Replaceable Carbide knives are harder, stronger, longer lasting and perform better on abrasive materials.

Versatility

One Router Bit gives you a wide variety of profiling options and can be used with Portable, or Industrial CNC machinery.

Safety

Chip Limitation design for safe operation. All Router bits have been tested for maximum stress by the German institute of Technology.

Service free

The Router Bits do not need sharpening. Simply replace the carbide knives.

Accuracy

Carbide knives have consistent and precise profiles for optimum and continued operation without adjustments.

Cost effective

Longer lasting knives, better performance, down time is minimal. Only Carbide Knives are replaced.

Easy to replace

Step by step instructions included, so you can do it yourself.

Chamfer Bit, 2 Flute, Type A

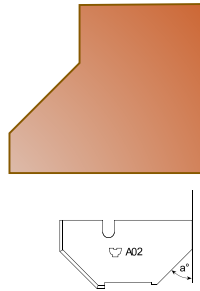
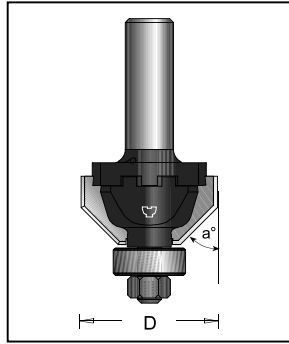
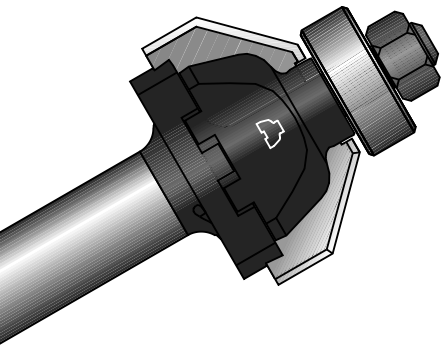

Tool no.	Blade #	D	Shank	a	Length	Category
N4-A01	A01	1 3/8"	1/4"	30°	2 5/8"	I
N8-A01	A01	1 3/8"	1/2"	30°	3"	I
N4-A02	A02	1 1/2"	1/4"	45°	2 5/8"	I
N8-A02	A02	1 1/2"	1/2"	45°	3"	I

Rounding Over Bit, 2 Flute, Type A

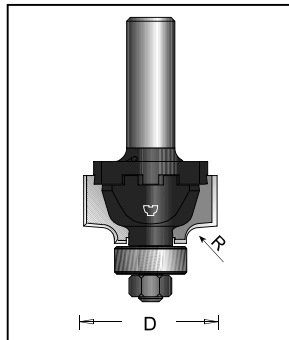
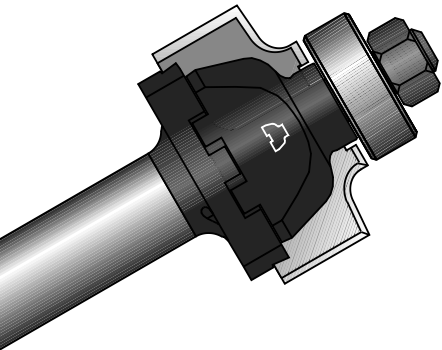

Tool no.	Blade #	D	Shank	R	Length	Category
N4-A03	A03	1 3/8"	1/4"	1/8"	2 5/8"	I
N8-A03	A03	1 3/8"	1/2"	1/8"	3"	I
N4-A04	A04	1 3/8"	1/4"	3/16"	2 5/8"	I
N8-A04	A04	1 3/8"	1/2"	3/16"	3"	I

Rounding Over Bit, 2 Flute, Type A

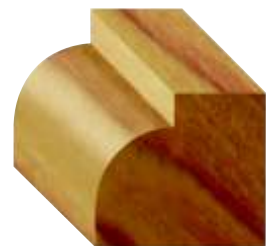
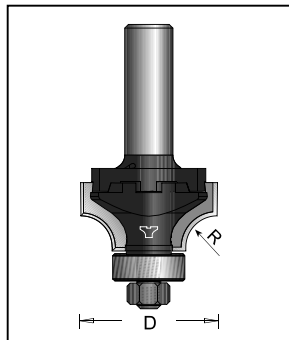
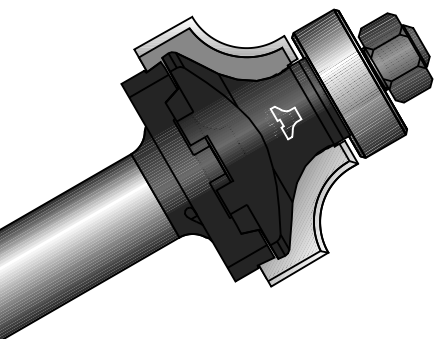

Tool no.	Blade #	D	Shank	R	Length	Category
N4-A05	A05	1 3/8"	1/4"	1/4"	2 5/8"	I
N8-A05	A05	1 3/8"	1/2"	1/4"	3"	I
N4-A06	A06	1 3/8"	1/4"	5/16"	2 5/8"	I
N8-A06	A06	1 3/8"	1/2"	5/16"	3"	I
N4-A07	A07	1 1/2"	1/4"	3/8"	2 5/8"	I
N8-A07	A07	1 1/2"	1/2"	3/8"	3"	I

Beading Roundover Bit, 2 Flute, Type A

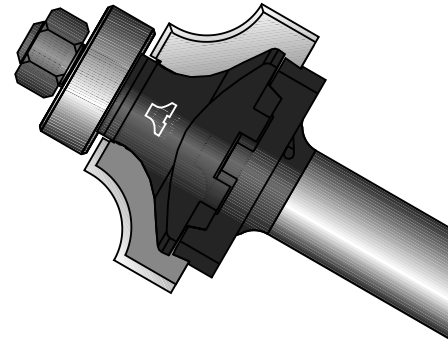
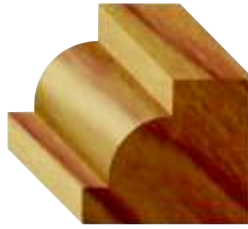
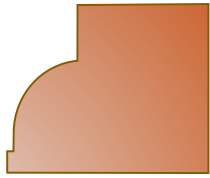
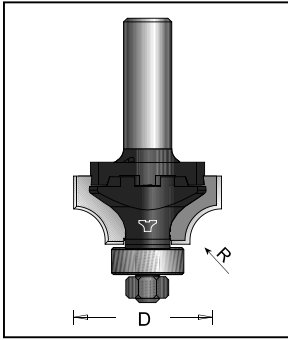

Tool no.	Blade #	D	Shank	R	Length	Category
N4-A08	A08	1 3/8"	1/4"	3/16"	2 5/8"	I
N8-A08	A08	1 3/8"	1/2"	3/16"	3"	I
N4-A09	A09	1 3/8"	1/4"	1/4"	2 5/8"	I
N8-A09	A09	1 3/8"	1/2"	1/4"	3"	I
N4-A10	A10	1 1/2"	1/4"	3/8"	2 5/8"	I
N8-A10	A10	1 1/2"	1/2"	3/8"	3"	I

Cove, 2 Flute, Type A

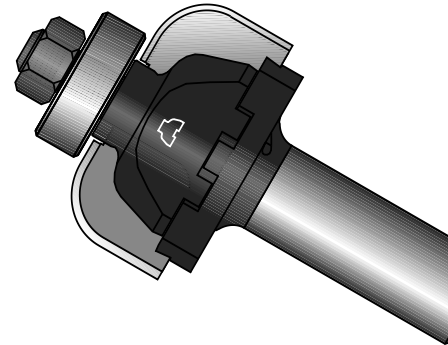
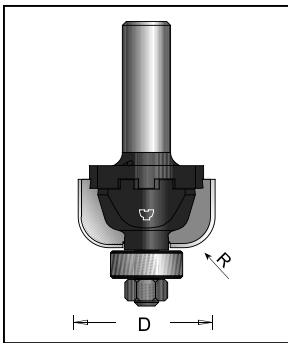

Tool no.	Blade #	D	Shank	R	Length	Category
N4-A11	A11	1 3/8"	1/4"	1/4"	2 5/8"	I
N8-A11	A11	1 3/8"	1/2"	1/4"	3"	I
N4-A12	A12	1 3/8"	1/4"	5/16"	2 5/8"	I
N8-A12	A12	1 3/8"	1/2"	5/16"	3"	I
N4-A13	A13	1 1/2"	1/4"	3/8"	2 5/8"	I
N8-A13	A13	1 1/2"	1/2"	3/8"	3"	I

Flat Ogee, 2 Flute, Type A

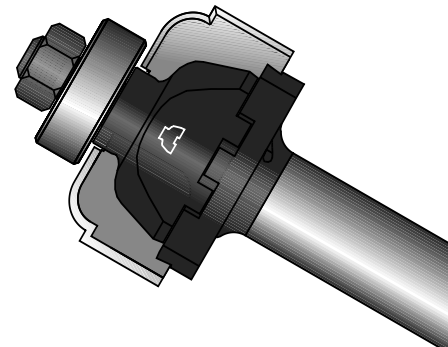
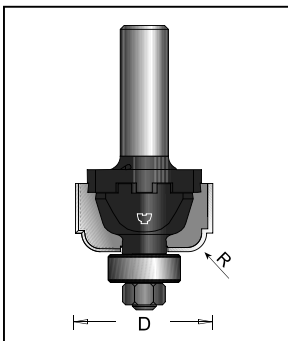

Tool no.	Blade #	D	Shank	R	Length	Category
N4-A14	A14	1 3/8"	1/4"	3/16"	2 5/8"	I
N8-A14	A14	1 3/8"	1/2"	3/16"	3"	I

Paneling, 2 Flute, Type A

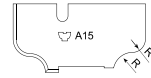
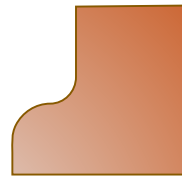
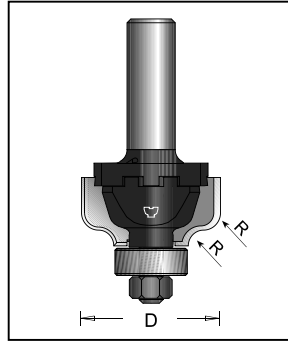
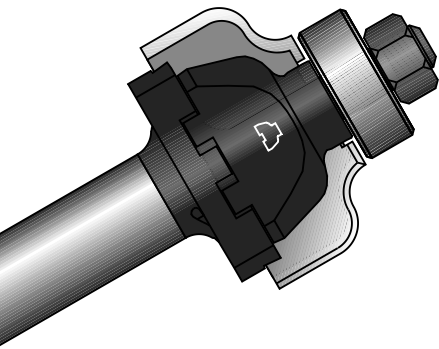

Tool no.	Blade #	D	Shank	R	R1	Length	Category
N4-A15	A15	1 3/8"	1/4"	5/32"	3/16"	2 5/8"	I
N8-A15	A15	1 3/8"	1/2"	5/32"	3/16"	3"	I
N4-A16	A16	1 1/2"	1/4"	5/32"	3/16"	2 5/8"	I
N8-A16	A16	1 1/2"	1/2"	5/32"	3/16"	3"	I

Roman Ogee, 2 Flute, Type A

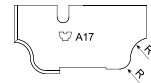
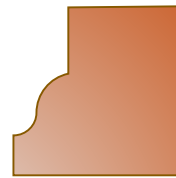
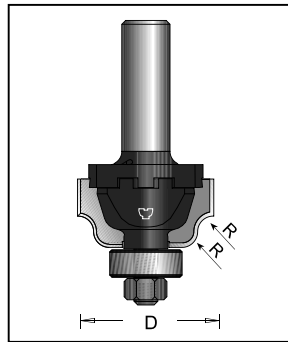
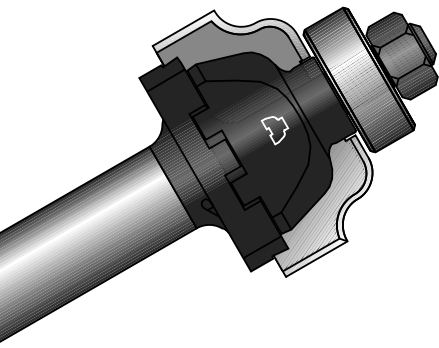

Tool no.	Blade #	D	Shank	R	Length	Category
N4-A17	A17	1 3/8"	1/4"	5/32"	2 5/8"	I
N8-A17	A17	1 3/8"	1/2"	5/32"	3"	I

Ogee Fillet, 2 Flute, Type A

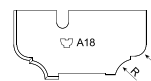
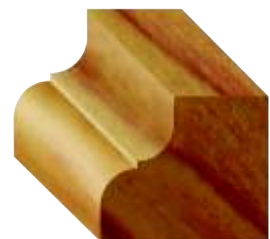
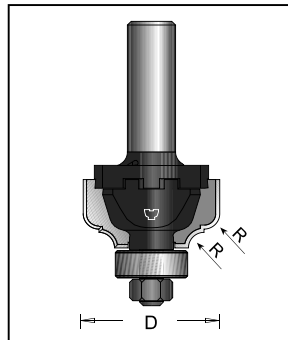
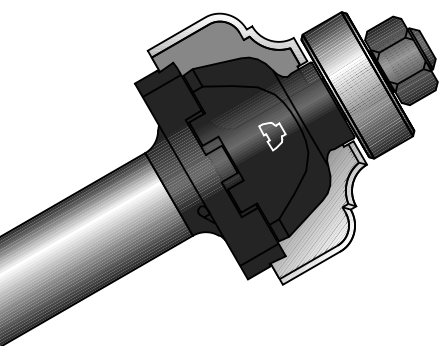

Tool no.	Blade #	D	Shank	R	Length	Category
N4-A18	A18	1 3/8"	1/4"	5/32"	2 5/8"	I
N8-A18	A18	1 3/8"	1/2"	5/32"	3"	I
N4-A19	A19	1 1/2"	1/4"	5/32"	2 5/8"	I
N8-A19	A19	1 1/2"	1/2"	5/32"	3"	I

Ogee Bead, 2 Flute, Type A

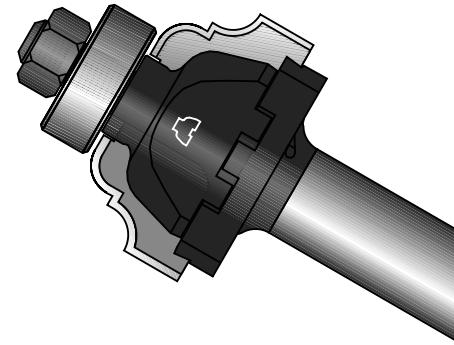
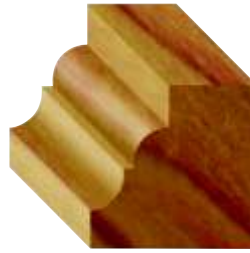
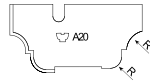
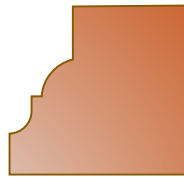
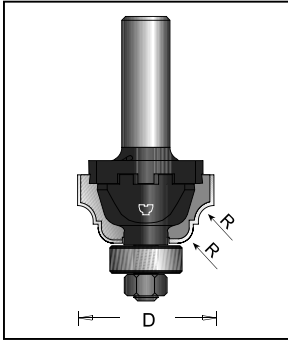

Tool no.	Blade #	D	Shank	R	Length	Category
N4-A20	A20	1 1/2"	1/4"	5/32"	2 5/8"	I
N8-A20	A20	1 1/2"	1/2"	5/32"	3"	I

Classic Panel, 2 Flute, Type A

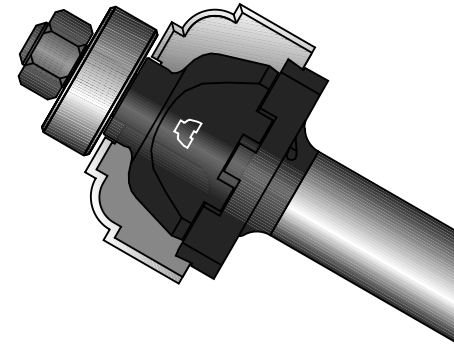
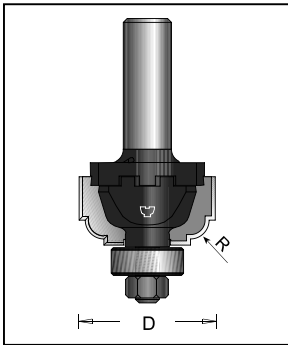

Tool no.	Blade #	D	Shank	R	Length	Category
N4-A21	A21	1 3/8"	1/4"	3/16"	2 5/8"	I
N8-A21	A21	1 3/8"	1/2"	3/16"	3"	I

Flat Ogee, 2 Flute, Type A

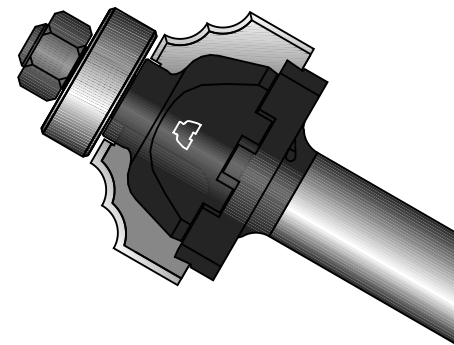
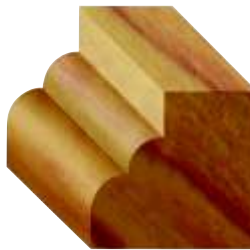
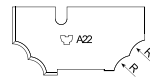
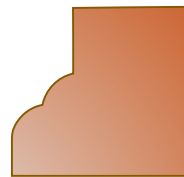
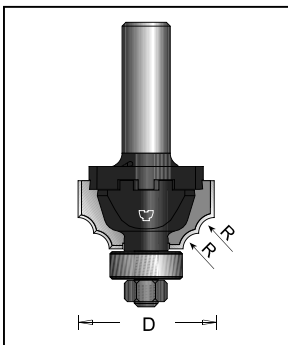

Tool no.	Blade #	D	Shank	R	Length	Category
N4-A22	A22	1 3/8"	1/4"	5/32"	2 5/8"	I
N8-A22	A22	1 3/8"	1/2"	5/32"	3"	I
N4-A23	A23	1 1/2"	1/4"	5/32"	2 5/8"	I
N8-A23	A23	1 1/2"	1/2"	5/32"	3"	I