

Super Rabbeting Cutter Sets - 1/2" Shank, 2 Flutes

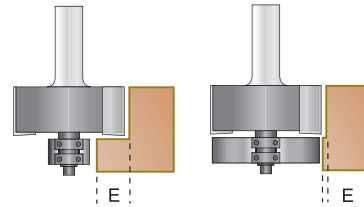

Tool no.	Description	Category
SRC-6A	6 piece Rabbeting Set: 1/8", 1/4", 3/8", 1/2", 5/8", 3/4"	R
SRC-12B	12 piece Rabbeting Set: 1/16", 1/8", 3/16", 1/4", 5/16", 3/8", 7/16", 1/2", 9/16", 5/8", 11/16", 3/4"	R
SRC-17C	17 piece Rabbeting Set: 1/16", 1/8", 3/16", 15/64", 1/4", 5/16", 23/64", 3/8", 7/16", 15/32", 1/2", 9/16", 19/32", 5/8", 11/16", 23/32", 3/4"	R

SRC-6A

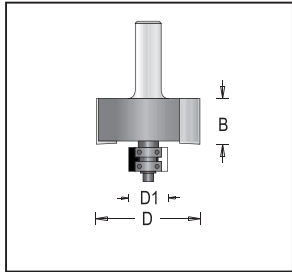

SRC-12B



SRC-17C



The ultimate rabbeting set that will perform rabbet cuts from 1/16" through 3/4" in 1/16" increments including five rabbet depths for undersized plywood such as 23/32".

Tool no.	Description	Rabbet Depth (E)	In Set	Category
1146108	Rabbeting bit D=2" x 1/2" Shank B=7/8" x Length =3 5/64"	5/8" & 3/4"*	● ● ●	R
BB-12A	Ball Bearing 1/2" x 1/4" x 3/16"			R
1950010	Washer			R
1920270	Spacer 2.2mm			R
1930040	Screw			R
1929900	Collar D1=47.6mm	1/16"	● ●	R
1929890	Collar D1=44.4mm	1/8"	● ● ●	R
1929880	Collar D1=41.3mm	3/16"	● ●	R
1929950	Collar D1=38.9mm	15/64"	●	R
1929870	Collar D1=38.1mm	1/4"	● ● ●	R
1929860	Collar D1=34.9mm	5/16"	● ●	R
1929940	Collar D1=32.5mm	23/64"	●	R
1929850	Collar D1=31.7mm	3/8"	● ● ●	R
1929840	Collar D1=28.6mm	7/16"	● ●	R
1929930	Collar D1=27.0mm	15/32"	●	R
1929830	Collar D1=25.4mm	1/2"	● ● ●	R
1929820	Collar D1=22.2mm	9/16"	● ●	R
1929920	Collar D1=20.6mm	19/32"	●	R
1929810	Collar D1=19.0mm	5/8"	● ● ●	R
1929800	Collar D1=15.9mm	11/16"	● ●	R
1929910	Collar D1=14.3mm	23/32"	●	R

Rabbeting Bit
Only

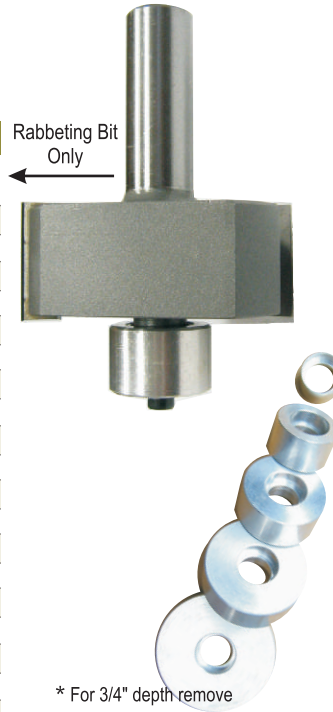

* For 3/4" depth remove the collar and leave the two ball bearings on.